

01418

Universal phase-cut dimmer 120-240 V~ 50/60 Hz, 2 outputs for incandescent lamps 40-300 W 240 V~, 20-150 W 120 V~, electronic transformers 40-300 VA 240 V~, 20-150 VA 120 V~, CFL lamps 10-200 W 240 V~, 5-100 W 120 V~, LED lamps 3-200 W 240 V~, 3-100 W 120 V~, push buttons for local control, By-me home automation system, protection fuse, installation on DIN rail (60715 TH35), occupies 4 modules size 17.5 mm.

2-output dimmer actuator with push buttons for manual operation. MOSFET microprocessor technology, works in both LE (Leading Edge) and TE (Trailing edge) modes and is equipped with protection fuse. The device receives commands directly from the bus and is able to control the load directly.

IMPORTANT: Lamps controllable from a single output must all be the same. All controllable loads must be declared DIMMABLE by the manufacturer. Check the type of compatible dimming on the lamp packaging: LE (Leading Edge) or TE (Trailing Edge). Where not specified, the lamp works in both modes, at the discretion of the installer; choose the type of dimming that ensures the best lamp operation.

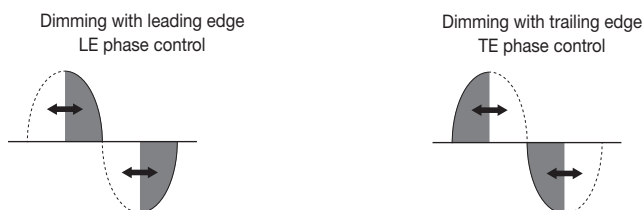

FEATURES.

- TP BUS Rated supply voltage: 29 V
- Network rated supply voltage: 120-240 V~, 50/60 Hz
- Dissipated power at 120 V: 12 W
- Dissipated power at 240 V: 5 W
- Absorption from TP bus: 15 mA
- Dissipated power: 5.5 W
- Terminals: N neutral, ~ load 1, ~ load 2, L phase, TP bus
- Parallelizable ~ load 1 and ~ load 2 outputs
- High breaking capacity fuse type F5AH250V
- Possible functions of the dimmer:
 - lights on, lights off and light control
 - absolute brightness change
 - "Flash Start" mode enabling for CFL lamps
 - "ramp" operation
 - off delay and warning function
 - phase control: LE/TE
- Protection against short-circuit on lighting with flashing-lamp blow-out detector.
- Thermal protection with flashing-lamp blow-out detector.
- Operating temperature -5 °C +45 °C (indoor)
- IP20 protection degree
- Dimmer 01418 should be configured with the Automation Gateway 01410-01411 and App VIEW Pro.
- Not compatible with By-me control panels 21509 and EasyTool Professional.

CONTROLLABLE LOADS FOR INDIVIDUAL OUTPUT.

- Controllable loads at 120 V~

Controllable loads	LE	TE
	20 - 150 W	20 - 150 W
	5 - 50 W (max 5 lamps)	5 - 100 W (max 10 lamps)
	3 - 50 W (max 10 lamps)	3 - 100 W (max 10 lamps)
	20 - 150 VA (max 3 type transformers)	20 - 150 VA (max 5 type transformers)
Power supply units 01874.120-01875.120	max 5 power supply units	Not applicable
Lamps 02662.120	max 5 lamps	Not applicable

- Controllable loads at 240 V~

Controllable loads	LE	TE
	40 - 300 W	40 - 300 W
	10 - 100 W (max 5 lamps)	10 - 200 W (max 10 lamps)
	3 - 100 W (max 10 lamps)	3 - 200 W (max 10 lamps)
	40 - 300 VA (max 3 type transformers)	40 - 300 VA (max 5 type transformers)
Power supply units 01874-01875	max 10 power supply units	Not applicable
Lamps 02662	max 10 lamps	Not applicable

N.B. The use of outputs in parallel makes it possible to control double the load specified per each individual output but the maximum number of lamps/transformers/power supply units that can be connected remains the same for each single output.

LOCAL CONTROLS.

Pressing the button enables the use of local buttons. All messages from the bus are ignored.

- Briefly pressing the button: Lights on control
- Briefly pressing the button: Lights off control
- Prolonged pressing of the button: Increase in brightness
- Prolonged pressing of the button: Decrease in brightness

In normal operation (that is when the commands are sent over the bus) pressing the buttons relating to the outputs is ignored.

LED indications

- All LEDs flashing at the same time: no mains voltage.
- Push button LED on: output configured in the By-me system with ON-OFF status.
- Push button LED flashing: current or thermal protection activated for the respective output.

CONFIGURATION.

For the configuration operations, see the By-me Plus system manual.

- Enrolment: once you have created the environments, when the App prompts you to press the device configuration push button:
 - we recommend you enrol the device with the load turned off;
 - press the CONF push button, the red LED is turned on;
 - with the red LED turned on, the App enrolls the device in the selected environment; the red LED is turned off once the operation is complete.
- Functional units: 3 (dimmer actuator 1, dimmer actuator 2, dimmer actuator 1+2).
- Functional unit selection: from the APPLICATIONS menu, follow the instructions shown by the App.

INSTALLATION RULES.

- Installation must be carried out by qualified persons in compliance with the current regulations regarding the installation of electrical equipment in the country where the products are installed.
- It should be used in dry, dust-free places at a temperature of between -5 °C and +45 °C.
- The lamps connected to it must all be the same.
- Not suitable for controlling motors (e.g. fans, ventilators).
- Never exceed the rated power.
- Overloads, electric arcs and short-circuits cause irreparable damage to the dimmer. Before installation check the circuit carefully and eliminate any of the above causes.
- The dimmer does not have a mechanical 1-way switch in the main circuit and so is not galvanically separated. The circuit load should be considered always powered.
- For further instructions see the manual enclosed with the control unit.

REGULATORY COMPLIANCE.

LV Directive.
EMC directive.
Standard EN 60669-2-5, EN 50491.
REACH (EU) Regulation no. 1907/2006 – Art.33. The product may contain traces of lead.



WEEE - User information

The crossed bin symbol on the appliance or on its packaging indicates that the product at the end of its life must be collected separately from other waste. The user must therefore hand the equipment at the end of its life cycle over to the appropriate municipal centres for the differentiated collection of electrical and electronic waste. As an alternative to independent management, you can deliver the equipment you want to dispose of free of charge to the distributor when purchasing a new appliance of an equivalent type. You can also deliver electronic products to be disposed of that are smaller than 25 cm for free, with no obligation to purchase, to electronics distributors with a sales area of at least 400 m². Proper sorted waste collection for subsequent recycling, processing and environmentally conscious disposal of the old equipment helps to prevent any possible negative impact on the environment and human health while promoting the practice of reusing and/or recycling materials used in manufacture.

FRONT VIEW

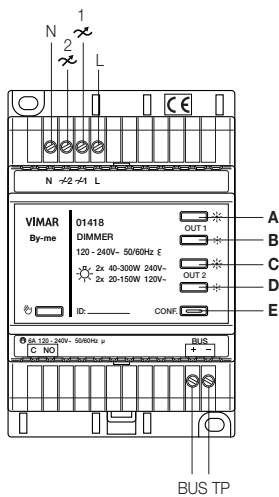

- A: Lights on and increase in brightness output 1
- B: Lights off and decrease in brightness output 1
- C: Lights on and increase in brightness output 2
- D: Lights off and decrease in brightness output 2
- E: Configuration push button and LED

FUSE REPLACEMENT

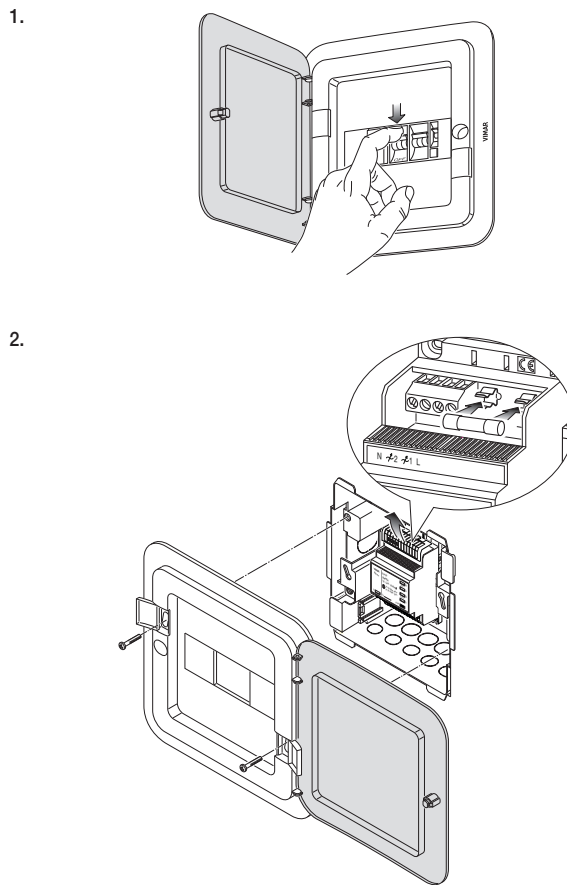

CONNECTIONS

Connection with separate outputs.

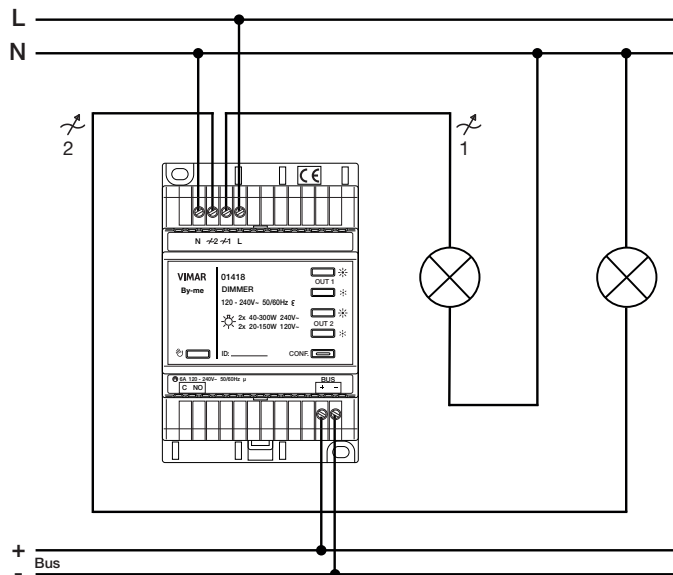

Connection with parallel outputs.

